

Mastercam

MULTIAXIS

Enhance your productivity with Mastercam
Multiaxis for intuitive programming of
complex parts.

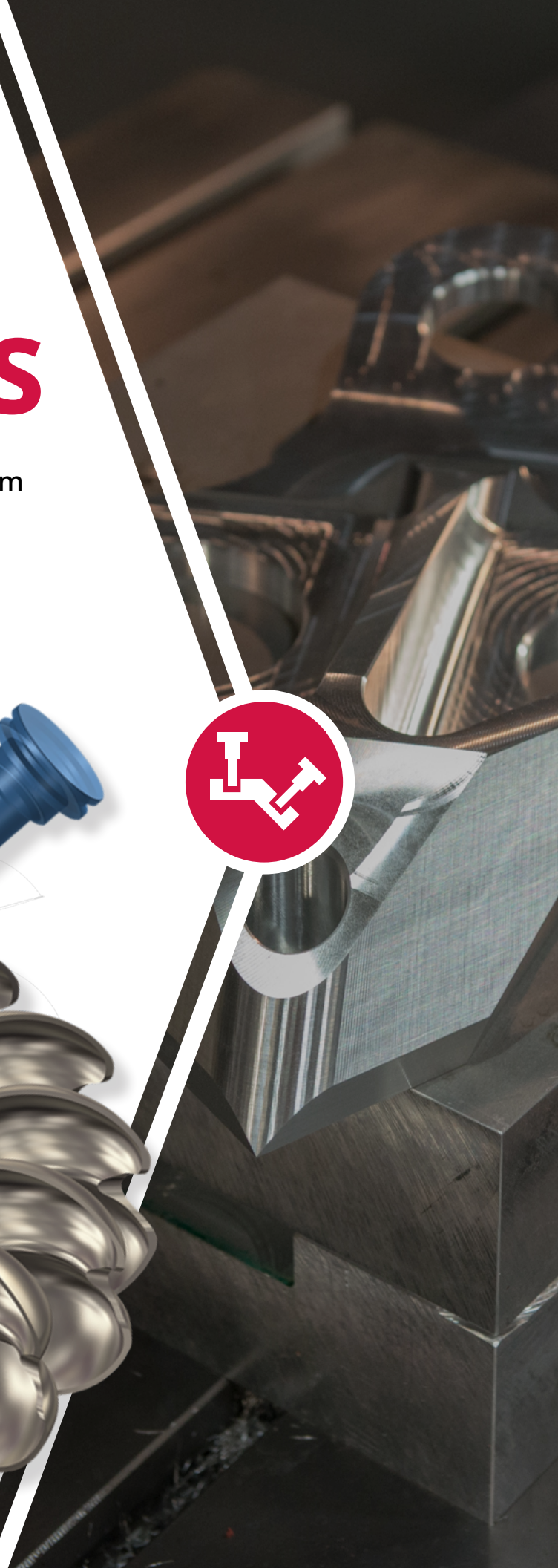

SIMPLIFIED ACCESS TO COMPLEX MACHINING

A practical solution to enhance productivity.

With Mastercam Multiaxis, you have complete control over the three crucial elements of multiaxis machining: cut pattern, tool axis control, and collision avoidance. From 4-axis rotary and roll-die cutting to multiblade impellers with tight internal cuts, Mastercam helps simplify even the most complex jobs with a wide range of multiaxis machining strategies — both basic and advanced — to improve your productivity.

Other highlights include:

- Multisurface 5-axis roughing and finishing (including depth cuts), plunge roughing, and flowline machining.
- Power and control of multiple multiaxis cutting strategies from a single interface.
- Automatic 3+2 roughing creates a single multiplane roughing toolpath for an entire part.
- Advanced gouge and collision detection, a “safe zone” around the part, and safe linking between operations.
- Fast, simple swarf cutting, 5-axis trimming, and stock-aware drilling.
- Ability to create full 5-axis motion from a 3-axis toolpath.

Mastercam Multiaxis provides the next step in productivity for programmers/machinists that have capitalized on the benefits of indexing/positioning in Mastercam Mill, Mastercam Router, and Mastercam for SOLIDWORKS®. Add this solution to your Mastercam license when you are ready to improve your capacity to machine increasingly complex parts on advanced CNC equipment.

From basic 5-axis contours to Dynamic roughing and complex finishing, Mastercam is built to streamline multiaxis programming.

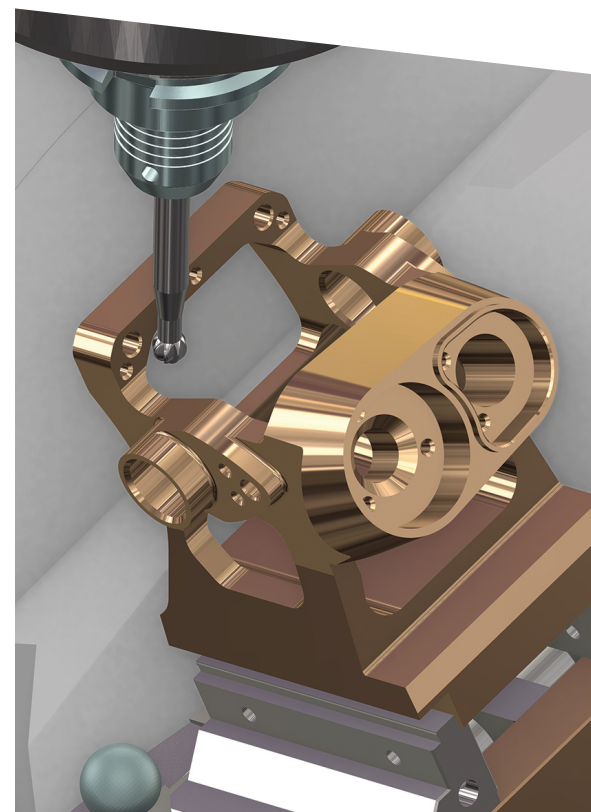

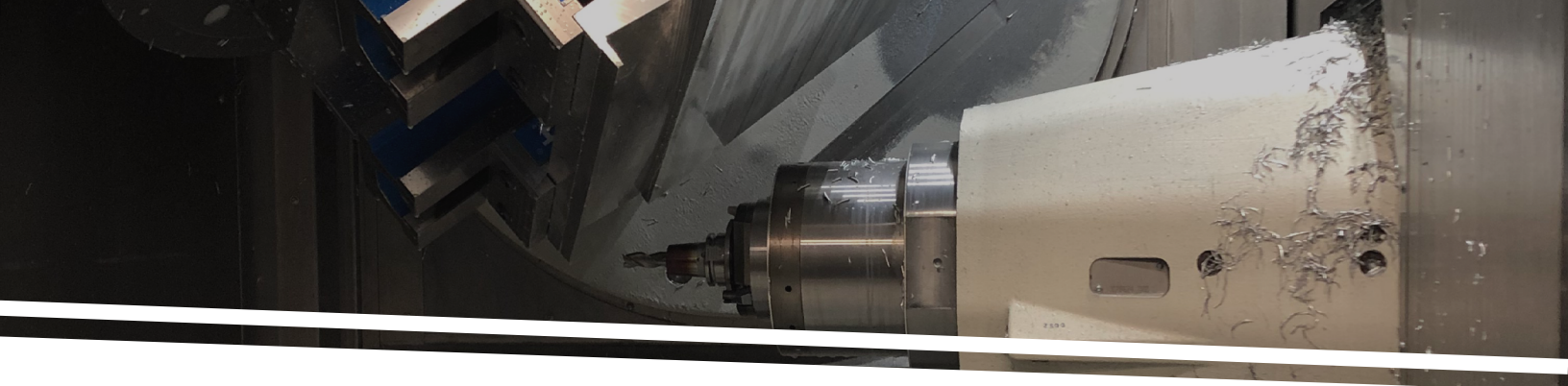

THE CHOICE IS YOURS

When you choose Mastercam, you get more than a license to run CAD/CAM software. You secure flexible options to empower your business and manufacturing operations — with the added value of shop-tested technology, responsive support, and a voice to guide future CAD/CAM developments.

FOR A MANUFACTURING SOLUTION THAT WORKS FOR YOU, CHOOSE MASTERCAM.



Trusted software and the world's largest CAM network give you the power to advance your manufacturing at a pace that works for you.



Perpetual licensing is available to operate Mastercam at a lower price over time, to complement long-term planning and budgeting capabilities.



Subscription licensing gives you lower up-front costs and renewable, term-based access to Mastercam with steady, predictable payments.



Mastercam Maintenance maximizes your productivity with priority access to the latest software, customer support, and so much more.

**For more information, contact a local Mastercam expert at
[Mastercam.com/Resellers](https://www.mastercam.com/Resellers).**

CNC Software, LLC
671 Old Post Road
Tolland, CT 06084 USA



www.mastercam.com

Mastercam®

Mastercam® is a registered trademark of CNC Software, LLC. All other trademarks are property of their respective owners.
©1983-2022. All rights reserved.