



# ***Mastercam***<sup>®</sup>

## **PRODUCT GUIDE**



MILL



MULTIAXIS



LATHE



SWISS



MILL-TURN



WIRE



ROUTER



DESIGN

# STRENGTH AND STABILITY IN MANUFACTURING

Mastercam is backed by a strong and stable company, supported by the world's largest CAM network. At a time when consolidation in the CAM industry has caused problems for many manufacturers — with questions about what to do with lagging software and where to find support — Mastercam users work with confidence.

With an uncompromising focus on the success of manufacturers using our CAD/CAM software solutions, Mastercam is developed using four strategic touch points for strength and stability in manufacturing.

## PERFORMANCE

### Powerful tools for speedy performance.

Mastercam is easy and intuitive to use but maintains a depth of features to support the most complicated jobs. Our toolpaths are elegant and remarkably efficient.

## PARTNERSHIP

### Focus and cooperation for innovation.

Our dedication to the manufacturing community drives Mastercam innovation. We collaborate with leading tooling, software, and machine tool manufacturers to develop new technologies.

## PRODUCTIVITY

### Advanced solutions for manufacturing.

We help connect the largest CAM community worldwide, and our success is a direct result of listening and responding to industry needs for productivity solutions from job setup to job completion.

## PROGRESS

### Managing resources for better results.

Opportunities to drive down costs and increase profits can be found across the entire shop. Mastercam supports improved use of data-driven manufacturing in the digital age.

**WORK WITH CONFIDENCE. CHOOSE MASTERCAM.**

## FLEXIBLE LICENSING OPTIONS MAKE IT EASY TO BRING THE WORLD'S LEADING CAD/CAM SOFTWARE INTO YOUR SHOP.



Subscription licensing gives you lower up-front costs and renewable, term-based access to Mastercam with steady, predictable payments.



Perpetual licensing is available to operate Mastercam at a lower price over time, to complement long-term planning and budgeting capabilities.



Mastercam Maintenance maximizes your productivity with priority access to the latest software, customer support, and so much more.

# TABLE OF CONTENTS

**02**

## **MASTERCAM'S INNOVATIONS FROM START TO FINISHING**

Dynamic Motion™ and Accelerated Finishing™.

**04**

## **MILL**

3D Dynamic OptiRough, Stock-aware roughing, refined 3D toolpaths, and more.

**08**

## **MULTIAXIS**

5-axis roughing and finishing, plunge roughing, and flowline machining.

**12**

## **LATHE**

Quick toolpaths, Custom thread forms, and more.

**14**

## **SWISS**

Machine-specific setup parameters, high-frequency turning, high pressure coolant, and more.

**16**

## **MILL-TURN**

Automated part transfers, tool planes, stock definition, and setup.

**18**

## **WIRE**

Efficient tab creation and management, straight or tapered cut from either direction, and more.

**20**

## **ROUTER**

Powerful 2D tools from nesting, contouring, pocketing, and drilling.

**22**

## **DESIGN**

Model Based Definition, Focused mesh, surface, and solid model creation.

**24**

## **EDUCATIONAL SUITE**

Empower students with the CAD/CAM skills they need.

**26**

## **CONNECTED CAM FOR A CONNECTED WORLD**

**28**

## **TOOLS TO KEEP YOURSELF COMPETITIVE**

Mastercam University®, Certification, and training.



# MASTERCAM'S INNOVATIONS

## DYNAMIC MOTION TECHNOLOGY IS A GAME CHANGER



Dynamic Motion® toolpaths safely maximize material removal rate, reducing cycle times by 25 to 75%. Dynamic Motion uses a proprietary software engine to continually adjust toolpath motion to maintain a constant chip thickness everywhere on the part. The result? Consistent machining performance, shorter cycle times, and longer tool life.

For more details and to see Dynamic Motion in action, visit [Mastercam.com/dynamic](https://Mastercam.com/dynamic).

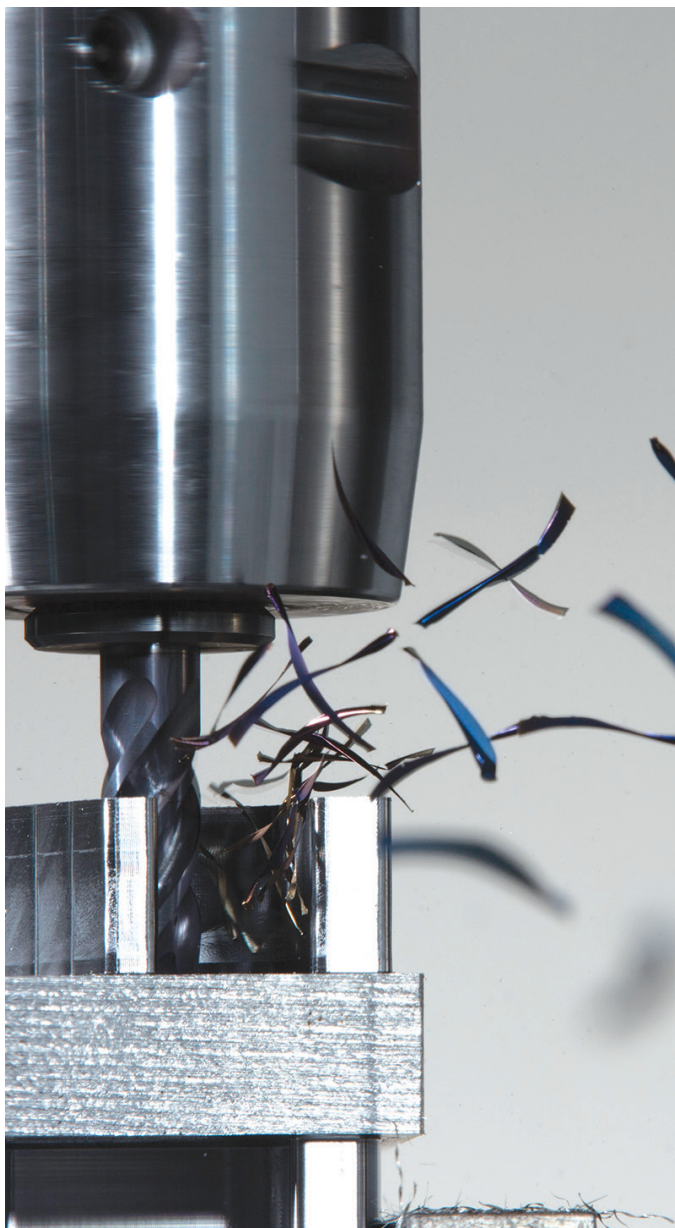

### SAVE TIME AND MONEY

100 titanium parts cut with and without Dynamic Motion toolpaths.

#### WITHOUT DYNAMIC



X

\$100/hour machine cost  
= **\$97.31**



\$97.31 per part x 100 parts  
= **\$9731**

#### WITH DYNAMIC



X

\$100/hour machine cost  
= **\$53.25**



\$53.25 per part x 100 parts  
= **\$5325**

45% reduction in cost



# FROM START TO FINISHING

## ACCELERATED FINISHING TECHNOLOGY IS REWRITING THE RULE BOOK

Mastercam's Accelerated Finishing® technology is the next leap forward in using today's innovative profile tools and delivering greater efficiency and higher machining productivity. Collaborating with the industry's best tool manufacturers, we take full advantage of these new tool designs to dramatically reduce finishing cycle times while improving surface finish.



For more details and to see Accelerated Finishing in action, visit [Mastercam.com/finish](https://Mastercam.com/finish).



### REDUCE CYCLE TIME

"We introduced Accelerated Finishing and a lens-shaped circle segment tool to an aerospace parts sub-contractor who machines aluminum structural parts. Cycle time decreased from 30 minutes to 3.5 minutes per part for an **88% improvement** and a cost savings of \$66 per part.

On a 1,000 part production run, it meant **a savings of over \$66,000.**"

Dan Doiron, Product Manager-Milling  
Emuge

# MILL

Mastercam Mill delivers CAD/CAM power and control with an intuitive programming interface.

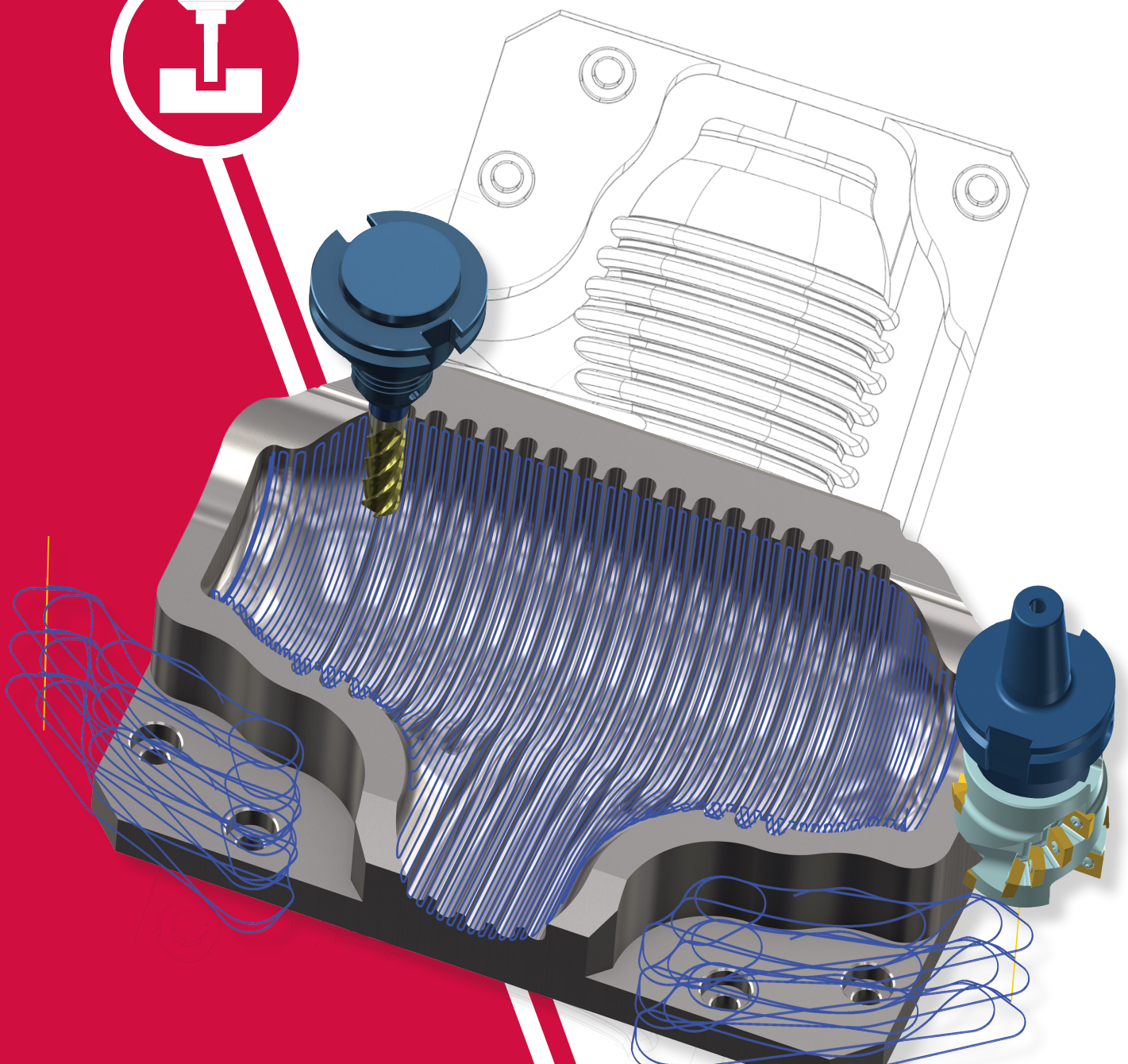



# PRECISION AND EFFICIENCY FROM DESIGN THROUGH THE PRODUCTION LINE

## Outperform your expectations.

Mastercam gives you the power to drive your CNC equipment with precision and efficiency. Our toolpaths help your machines achieve a reliable, efficient, smooth, and accurate motion. Part quality, extended tool life, and repeatability — even the longevity of your machines — are directly related to this motion.

*Mastercam's active Stock Model, Toolpath Verification, and Simulation mean increased confidence on every project. Tool library support, including CoroPlus® and MachiningCloud, helps you make tooling decisions fast.*

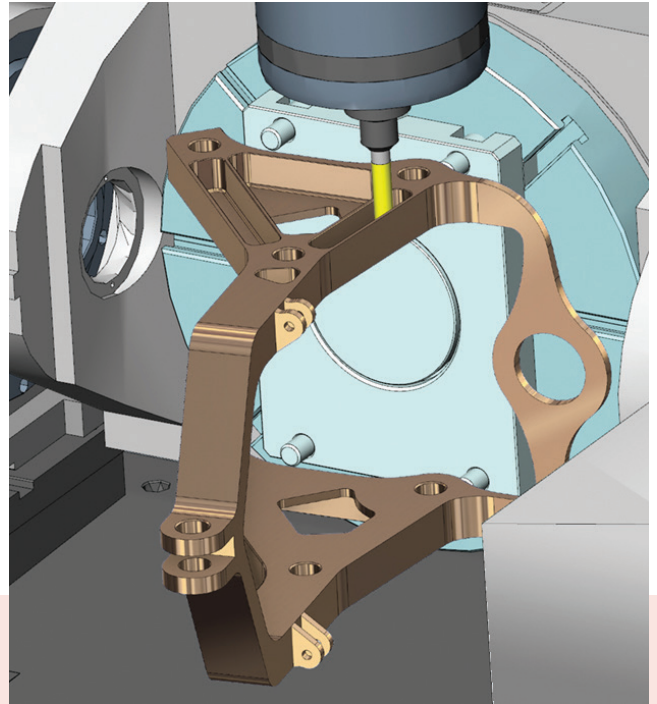

## IT ALL ADDS UP TO SAVINGS

*"Dynamic Motion takes all the material away in one simple, continuous, non-stop, uninterrupted cut. Not only does that make better parts faster, because it's not lifting, stopping, and starting again, but it also extends the life of the tool."*

James Nunn, Owner  
Machine Nunn

## Flexible, expandable, and connected.

Comprehensive toolpath strategies provide multiple approaches for programming any part, regardless of complexity. Modify any element, and toolpaths are updated, eliminating rework.

Build libraries of your favorite machining strategies. Choose customized operations, apply them to your next job, and reduce your programming time. With interfaces to digital tool libraries and other manufacturing software, Mastercam ensures you are ready for the next digital revolution. Fast, easy, productive — the way programming should be.

*Mastercam Mill has been shop-tested more than any CAM program in the world. You can count on Mastercam for real-world, proven results.*



# 2D MILLING

From simple to complex, Mastercam Mill's 2D machining capability delivers the tools you need to compete.

- 3D power for your 2D parts — fast, automated 3D Dynamic OptiRough is included in all Mill products (Entry excluded).
- Feature Based Machining (FBM) automatically programs prismatic solid features like drill holes, contours, and pockets.
- Easy, safe, highly-automated hole making.
- Precision chip control for a wide set of tools, plus specialized tool support including ISCAR®'s High Efficiency Machining (HEM) tool set and more.

Dynamic Motion powers much of our 2D solutions. It allows you to maximize your material removal rate to minimize cycle time.

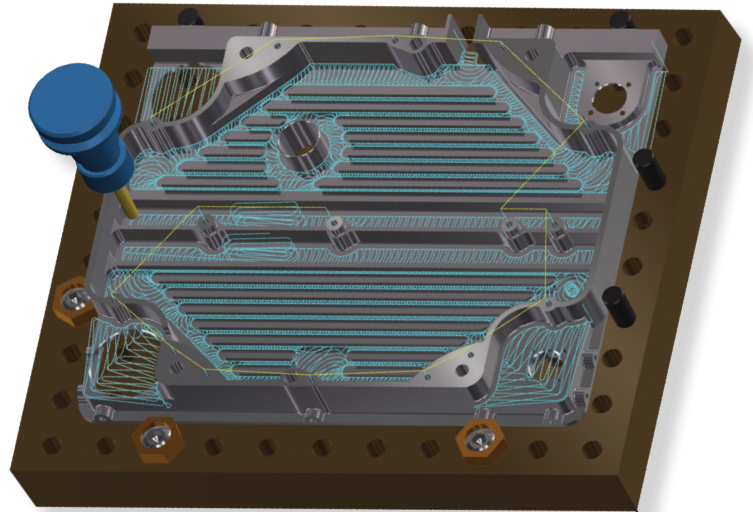

*Mastercam's 2D toolpaths deliver easy and optimized pocketing, contouring, drilling, facing, and much more.*

## TRIM YOUR PRINT-TO-PART TIMELINE

*"For 2D users — those that do a lot of pocketing and contouring — Dynamic OptiRough is a game changer for programming prismatic parts. Previously only available to 3D users, this toolpath lets you rough an entire prismatic solid part fast, in one operation instead of individual roughing, pocketing, and contouring toolpaths. It's an incredible time saver."*

Jesse Trinque, Applications Engineer  
Mastercam Manufacturing Lab

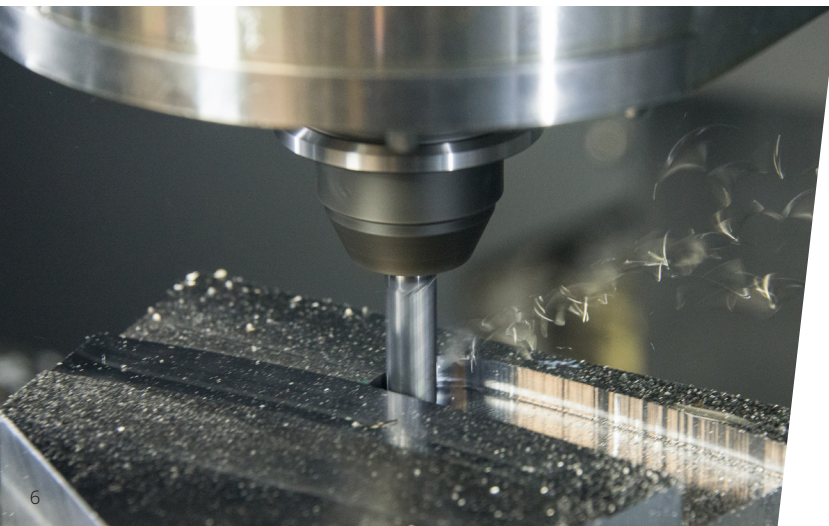



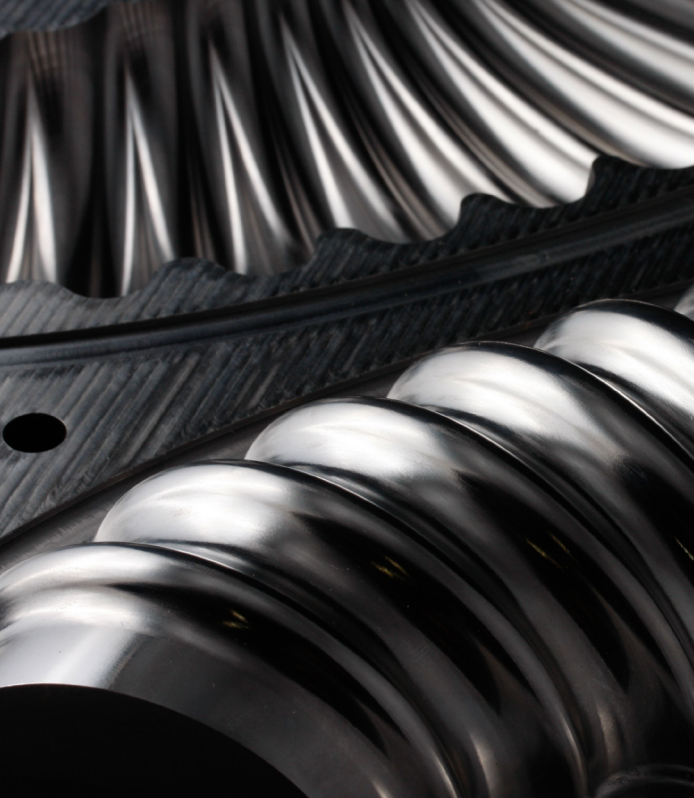

*The proof of any CAM software is what comes off the machine. Mastercam is crafted to help you get the best possible finish in the shortest amount of time.*

## 3D MILLING

Mastercam provides unsurpassed control on surface cuts, delivering superior finishes and optimized cycle times.

- Stock-aware roughing, remachining, semi-finishing, and finishing ensure precision parts.
- Mastercam's Dynamic Motion technology powers dramatically efficient roughing.
- Constant scallop machining maintains a consistent finish on sloped and flat surfaces.
- Constant-Z rest milling (remachining) identifies and machines areas needing a smaller tool.
- Smart control over motion between cuts for smooth, efficient results.
- Hybrid finishing creates a single toolpath that changes cut methods as the slope changes.

Cut multiple surfaces, solid models, and mesh data — our refined 3D toolpaths give you a smooth, precision finish to please even your toughest customers.

## MASTERCAM'S SPECIALIZED ADD-ONS

Often, that one additional CAD or CAM tool makes a specific job easier, faster, and more profitable. If you need very specialized options to precisely match your customer, your workflow, or your products, Mastercam Add-Ons can help.



### Port Expert

Create precision engine cylinder head porting toolpaths on surface or solid data, while minimizing unnecessary motion.



### Blade Expert

Highly efficient toolpaths for multibladed parts, delivering superior blades, splitters, floors, and fillets.



### ProDrill

Automatically detect, group, and apply drill strategies to large amounts of holes, and automatically create tool definitions from existing geometry.



### 5-Axis Curve Machining and Drilling

A targeted and powerful multiaxis technique that adds extra flexibility to your milling; can be upgraded to the full Multiaxis product.



### Mastercam Productivity+™

Brings Renishaw® in-process probing and inspection to your Mastercam programs. Easily set up, validate, and even make in-process adjustments where appropriate.



### Art

Quickly bring your 2D sketches, clip art, photos, and CAD files to life by crafting them on-screen and cutting them with easy, specialized toolpaths.

# MULTIAXIS

Enhance your productivity with Mastercam  
Multiaxis for intuitive programming of  
complex parts.

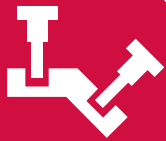

# SIMPLIFIED ACCESS TO COMPLEX MACHINING

## A practical solution to enhance productivity.

Mastercam's Multiaxis is a powerful 4- and 5-axis solution that can work in conjunction with Mastercam Mill 3D, Mastercam Router 3D, and Mastercam Mill-Turn. This product maintains stock model awareness, a 5-axis safe zone around the machined part, and tilt axis limits on the tool angle to avoid violating machine limits for the safest machining possible. It also comes with extensive dynamic-style roughing capabilities for going beyond 3+2 roughing and into full simultaneous motion material removal. The abilities of Multiaxis, which range from standard to advanced, give users complete control over cut pattern, tool axis, and collision avoidance.

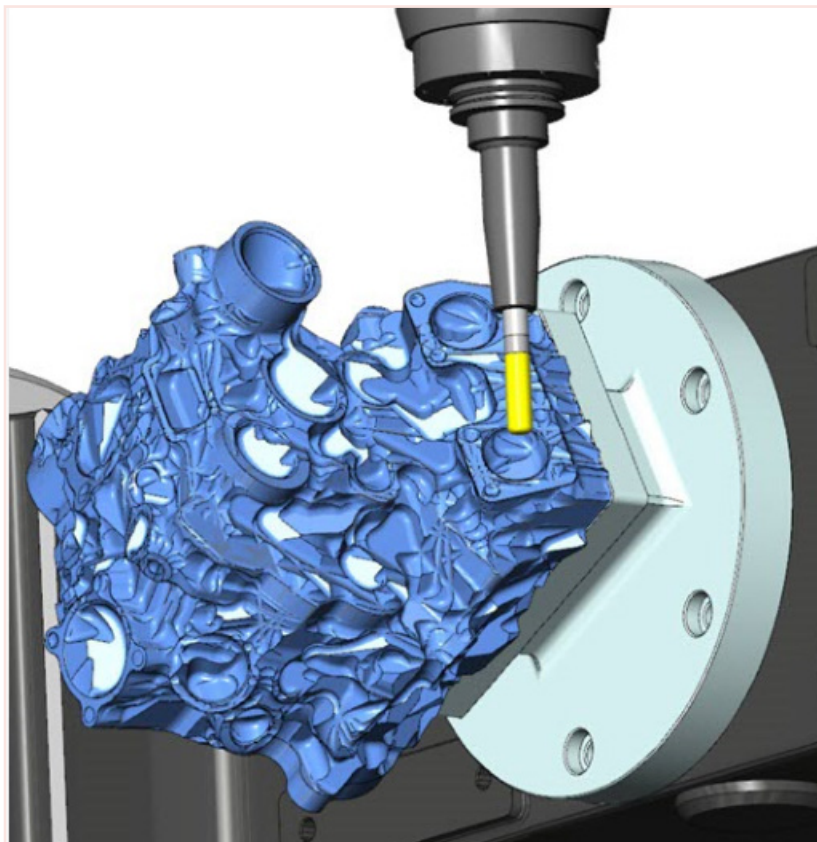

**Cut Patterns**, ranging from simple 2D wireframes to complex multisurface grids, guide the cutting along predetermined paths. These varied toolpaths optimize cutting while ensuring safety.

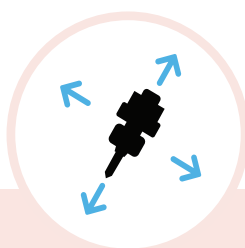

**Tool Axis Control** gives users the ability to specify tool axis, lead/lag, entry/exit, and tilt. This technology orients the tool's center axis as it follows the cut pattern, and it uses advanced gouge checking and a 5-axis safe zone during machining to protect the part.

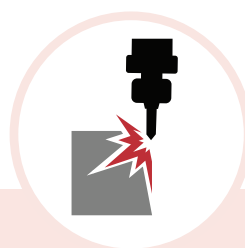

**Collision Control** provides a "near miss tolerance" field so that users can choose exactly how close they want to allow the tool to approach any workholding or machining component.



## Popular Multiaxis Toolpaths

**Unified 5-axis:** New to Mastercam 2022 and the result of customer feedback, with the Unified toolpath, users need to only select their Machining and Avoidance geometries once before being able to experiment with Cut Patterns. Not needing to reselect geometries every time will save mouse miles and time.

**Deburr 5-axis:** Sharp edges are common occurrences on completed parts. Deburring those edges is a challenging manual task, and keeping up consistency is nearly impossible, but Deburr 5-axis automates this process.

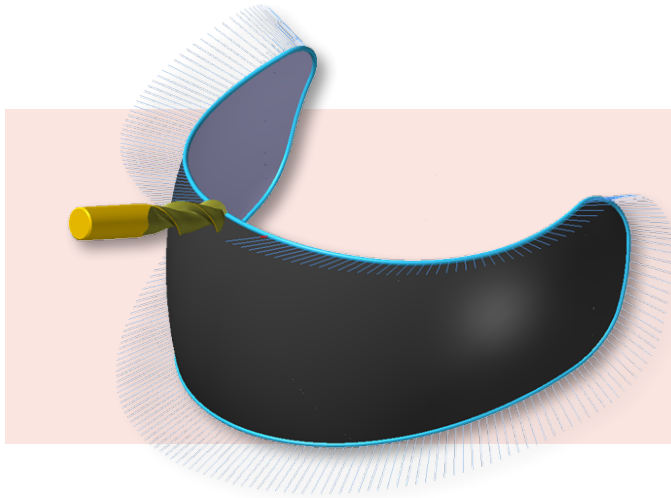
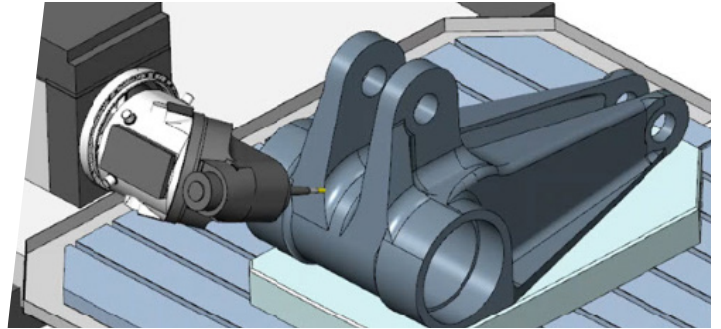

**Curve 5-axis:** This toolpath is one of Mastercam's oldest and most popular. The cut pattern follows a curve (a line, a spline, a circle, or a surface edge) that can be wireframe, solid, or surface.

**Swarf 5-axis:** Sometimes called "Flank-milling", Swarf 5-axis uses the side of a tool to cut a wall. It is very popular in aerospace milling.



**Tilt to Avoid:** Available in Mastercam's 3D HST Finishing paths, Tilt to Avoid is the fastest way to add Multiaxis motion to a 3-axis toolpath. With just one click, the tool assembly is checked against the machining and avoidance geometries and introduces tilt where necessary to machine the path.

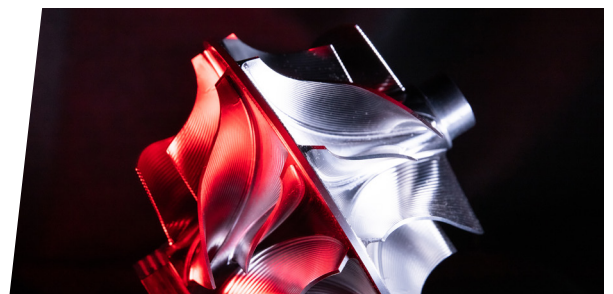
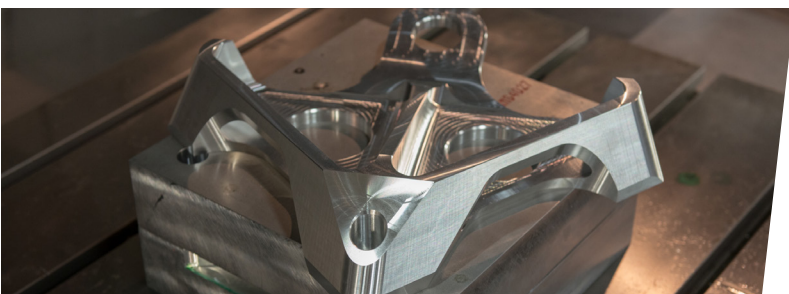



## Make it Multiaxis

Multiaxis machining expands on the traditional 3-axis machine's motion abilities. Instead of moving along three simple linear axes, Multiaxis machines can move in four or more directions by adding rotary axes and parallel linear axes. Some modern Multiaxis centers can use nine axes, but most use only four or five simultaneously.

Launching into the Multiaxis world can be — understandably — daunting. In the past, access to training resources could be limited, and often, the only publicly available material came from forums or user YouTube videos. While these are still valuable resources, Mastercam has taken steps in recent years to make learning easier. Mastercam University is an online learning center full of self-directed courses that walk users through simple and advanced machining topics. It has a full, end-to-end Multiaxis course on all our toolpaths and on standard Multiaxis machining concepts as well.

*Make it quicker. Make it easier. Make it yours. **Make it Multiaxis.***

Mastercam and its Resellers have also produced and released extensive official YouTube tutorials on everything from individual toolpath use to fully-fledged examples with real parts. Many Resellers also offer training at their locations or will even visit your shop, and all of them will have their own Multiaxis resources and experts to give you a leg up. If you want in-person training, reach out to your local Reseller as a first step.

**To learn more about Mastercam's Multiaxis solutions, visit [mastercam.com/multiaxis](https://mastercam.com/multiaxis).**

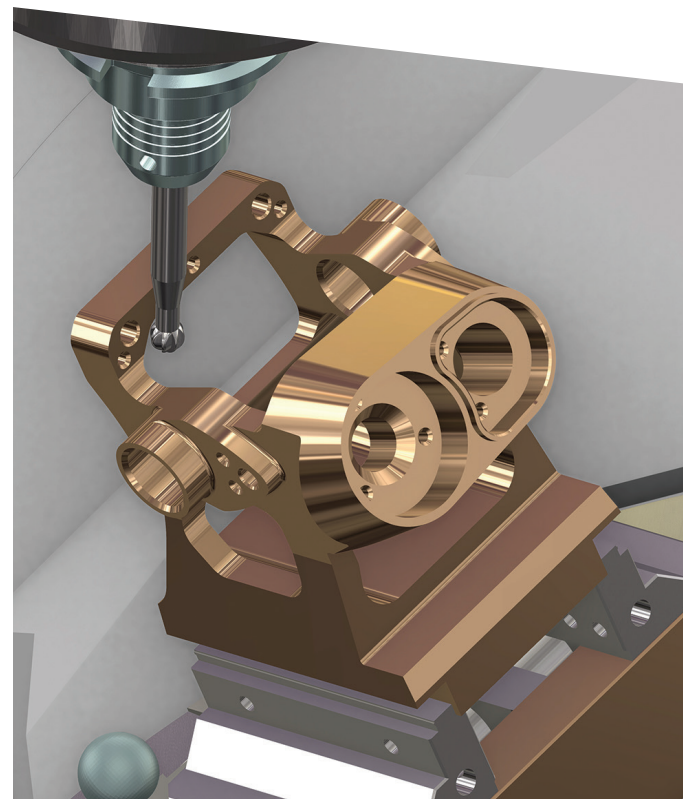
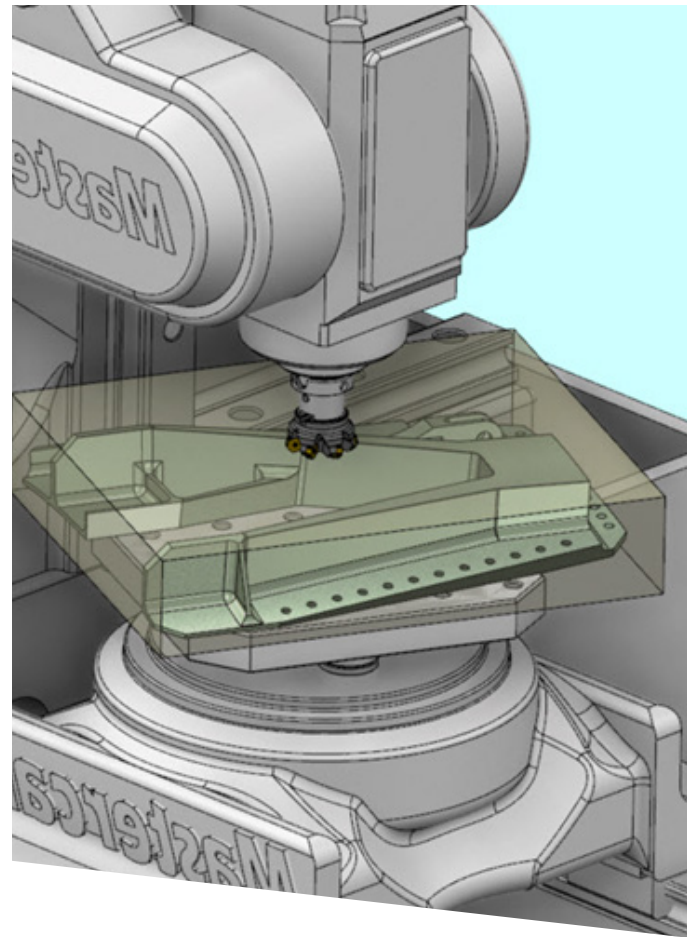

# LATHE

Mastercam Lathe lets you move the same part file between milling and turning operations with ease and confidence.

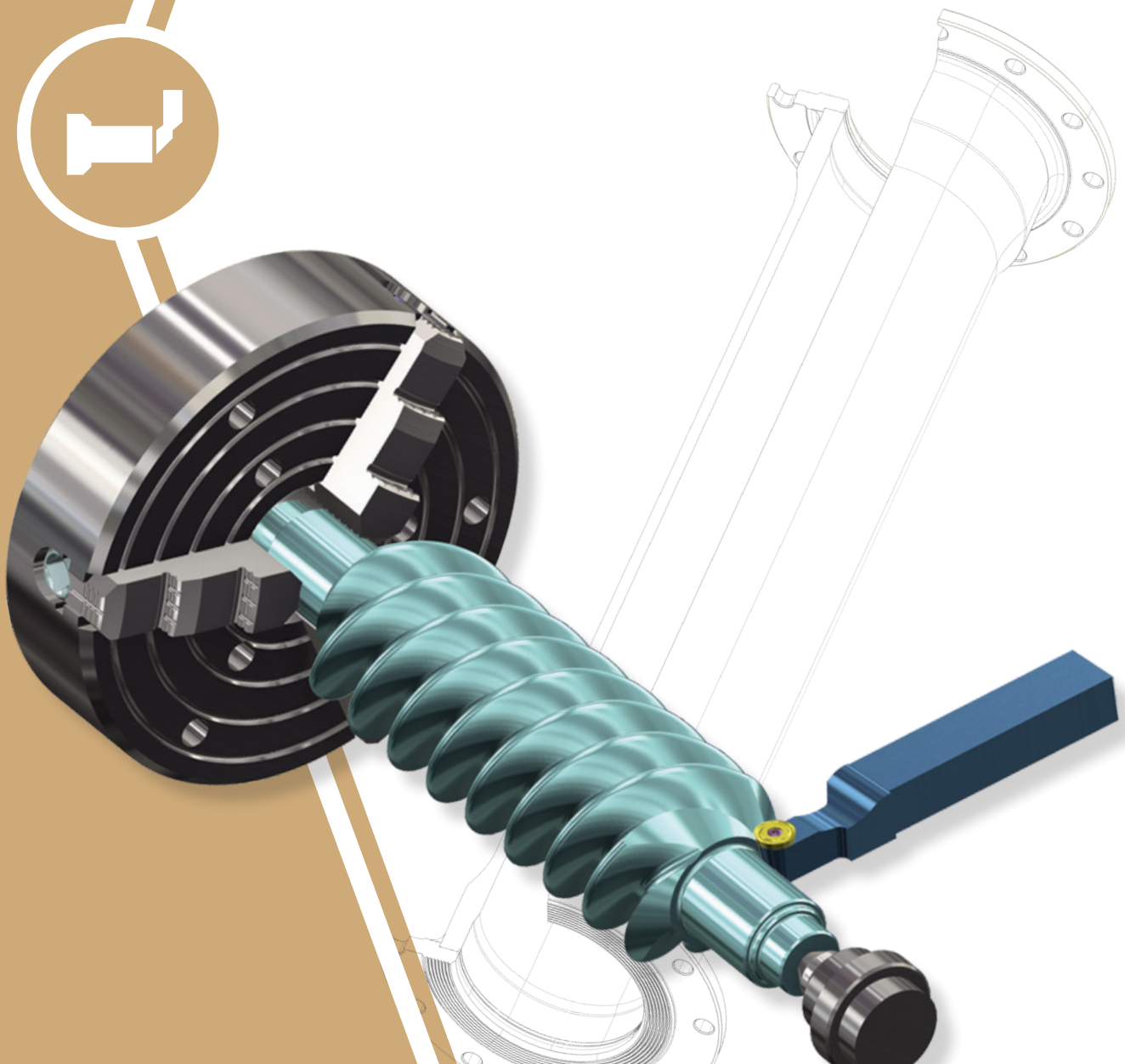

# POWERFUL, FLEXIBLE TOOLS FOR TURNING

## A set of tools that streamline your entire process.

From importing CAD files to Dynamic roughing and precision finishing, Mastercam Lathe gives you a variety of strategies to turn parts with greater efficiency and productivity.

## Efficient programming, designed for modern manufacturing.

Mastercam Lathe delivers a set of easy-to-use, advanced programming tools, with greatly expanded options when paired with Mastercam Mill. Easy rough, finish, thread, groove, bore, and drill routines combine with C/Y-axis machining to cut any job. Dependable toolpath verification ensures your parts are done right the first time.

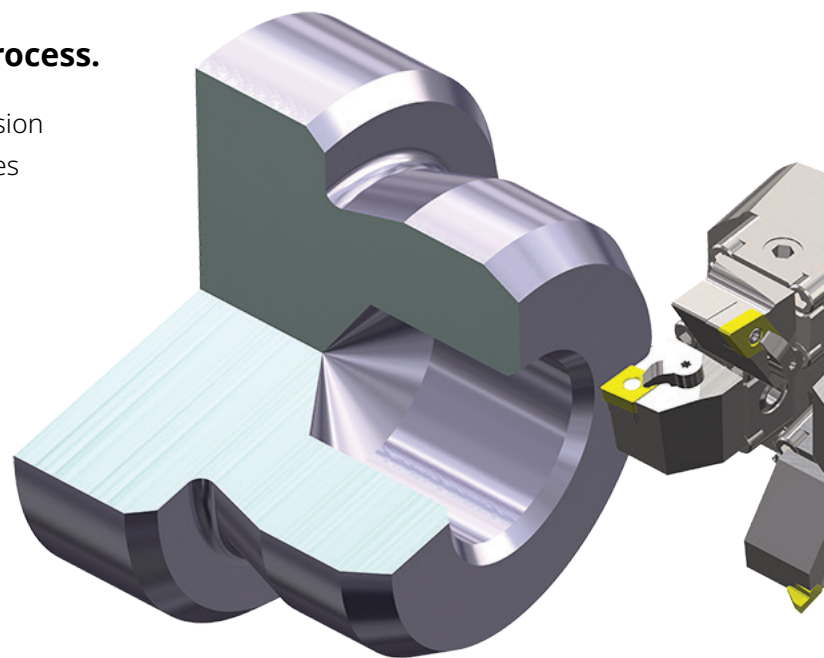

## Fast, easy turning.

- Program in a few clicks with **Quick Toolpaths**.
- Complete threading including **custom thread forms**.
- Grooving with multiple depth cuts, peck motion, and full-radius plunge turning.
- Intelligent ID, OD, face roughing, and finishing.
- **Full milling support available** for machines with live tooling or C and Y axes.

## Safe machine and cut control.

- Chuck, part, steady rest, and tailstock detection.
- Automatic gouge checking on the tool's front and back.
- Control chip breakage on difficult-to-machine materials.
- Full collet and solid jaw support.
- Expanded job setup, part transfer, and programming options on select lathes.

## SAVE TIME AND MONEY

100 Hastelloy parts cut with and without Dynamic Motion toolpaths.



X

### WITHOUT DYNAMIC

\$100/hour machine cost = \$500

12.5 inserts per part @ \$25 = \$312.50

\$812.50 per part x 100 parts

= \$81,250



X

### WITH DYNAMIC

\$100/hour machine cost = \$66

1.5 inserts per part @ \$25 = \$37.50

\$103.50 per part x 100 parts

= \$10,350



Cycle time and cost reduction of 87%

# SWISS

Use the intuitive Mastercam platform to drive Swiss-style machines with powerful accuracy.

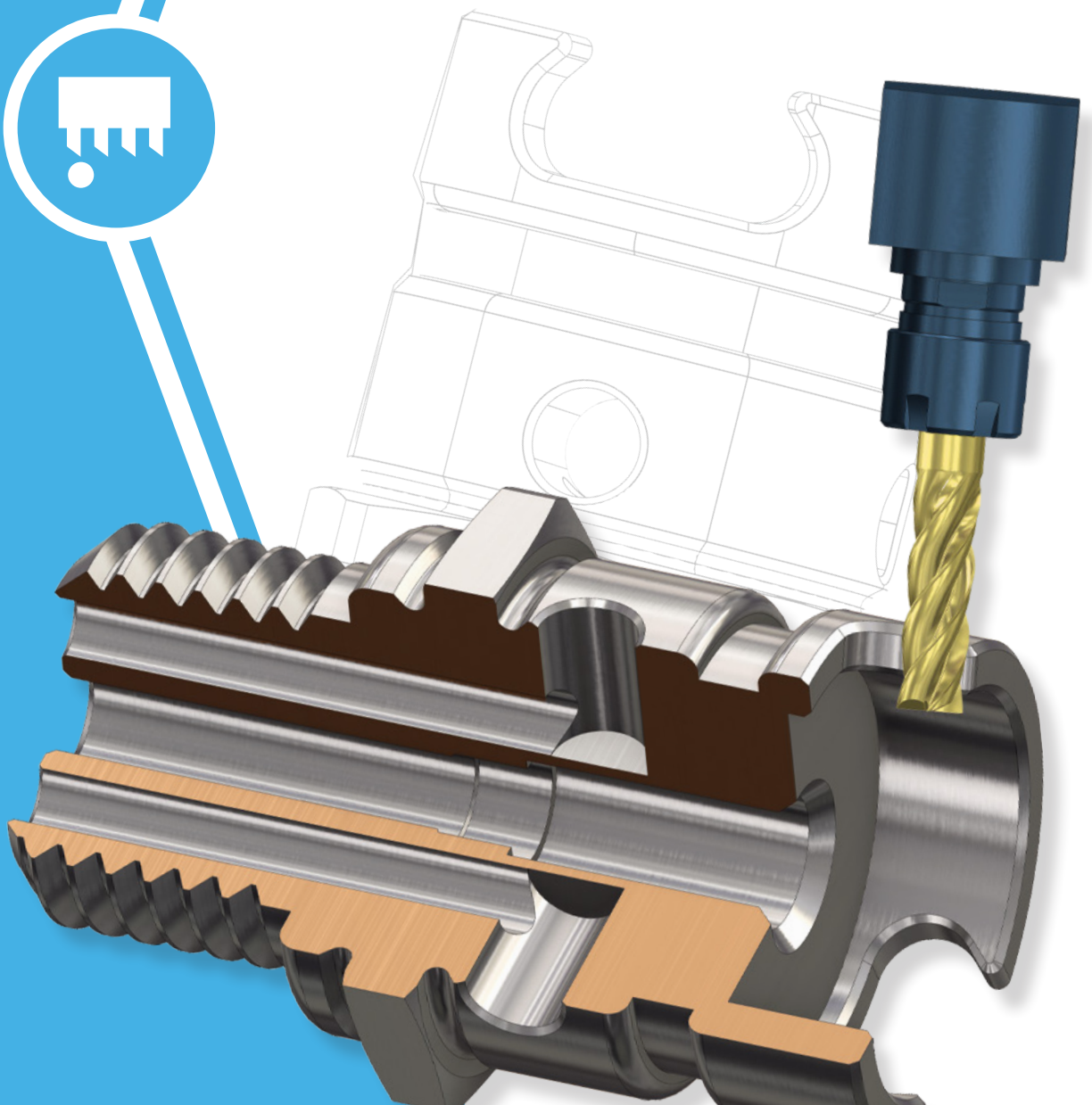
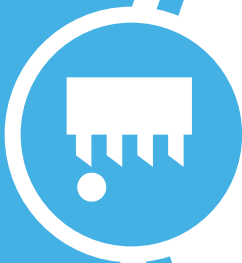



# CUSTOMIZED, BUNDLED TECHNOLOGY

## Consolidated software can standardize your shop.

You no longer need a separate software package for Swiss machines — something programmers and machinists appreciate.

Our Swiss machining solutions combine Mastercam Mill and Mastercam Lathe with specialized post processors. This configuration adds machine-specific controls inside the Mastercam interface, delivering accurate G-code for a wide variety of Swiss machines.

The solution provides customized choices directly within Mastercam for:

- Swiss-style bar feed stock advance.
- Machine-specific setup parameters.
- Swiss-style pick off / cut off strategies.
- Expandable custom machine options including lasers, high-frequency turning, high-pressure coolant, and more.

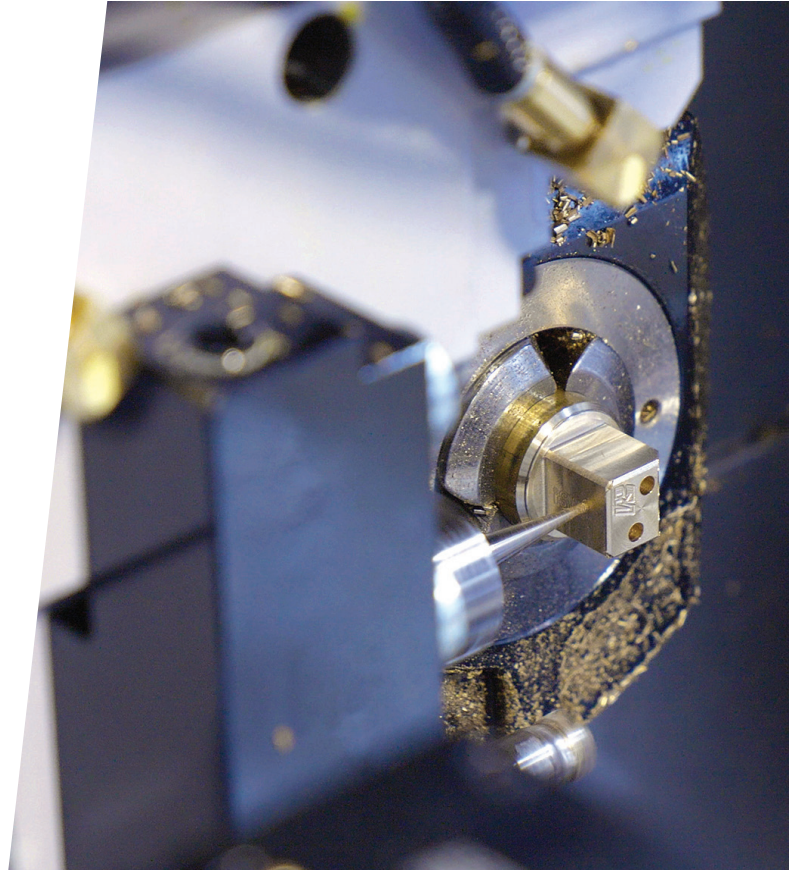

*Mastercam's industry-leading milling and turning power combine to deliver efficient, precise Swiss programming.*

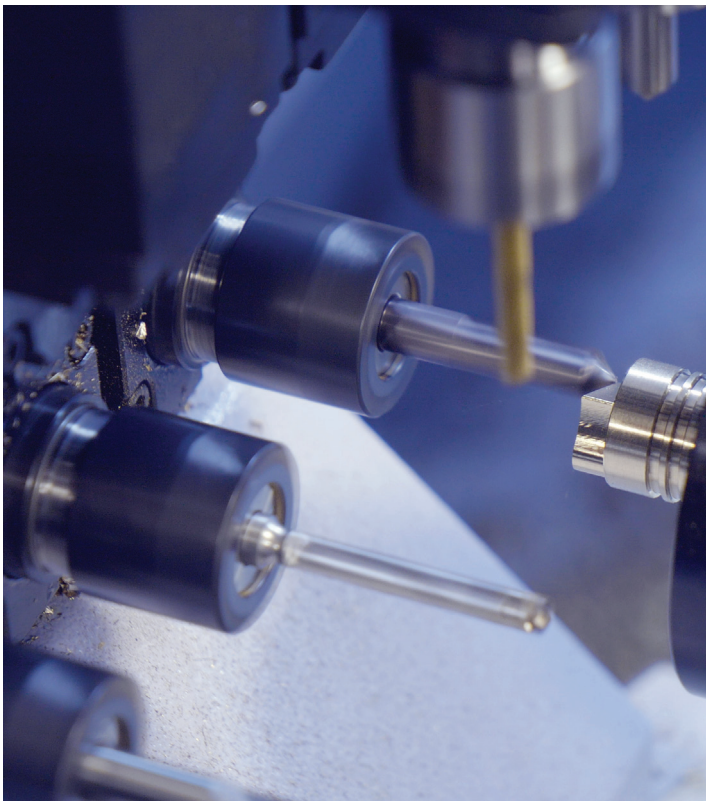

## Support an array of Swiss machines with the ease of Mastercam.

Mastercam Swiss Solutions cover gang-style machines and limited gang-turret and B-axis machines. Optimized post processors are available for machines from manufacturers including:

- |           |            |
|-----------|------------|
| • Star    | • DMG MORI |
| • Tsugami | • Hanwha   |
| • Citizen | • Ganesh   |
| • Swistek | • Nexturn  |

*Machine-specific options within Mastercam ensure you have precise control and solid code.*

# MILL-TURN

Automate your complex programs for high-powered, multitasking machining centers. Program it right the first time, every time.

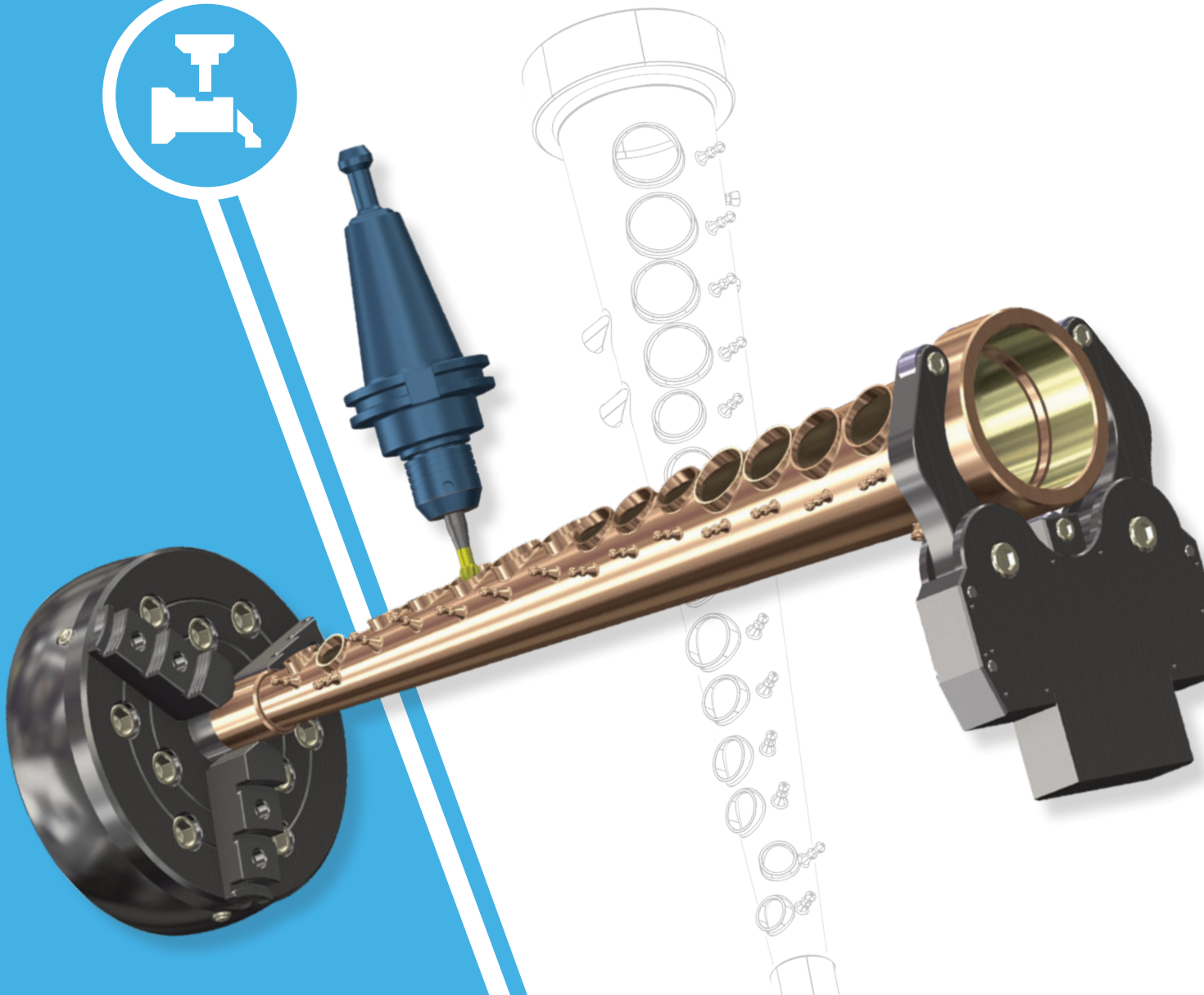



# STREAMLINED MACHINING CAPABILITIES

## Mastercam Mill-Turn simplifies control of high-powered, multistream machining centers.

With Mastercam, your workflow is efficient. Choose your machine, and Mastercam Mill-Turn automates part transfers, tool planes, stock definition, and setup. Then apply your toolpaths, quickly synchronize them, verify your project with simulation, and post your code. Changes along the way are fast and easy — the way programming should be.

Mill-Turn's Sync Manager is a user-friendly way to optimize part cycle times and manage interactions between toolpath operations. Easily navigate a Gantt-style timeline and vertical stream interface to coordinate operations and track cycle times.

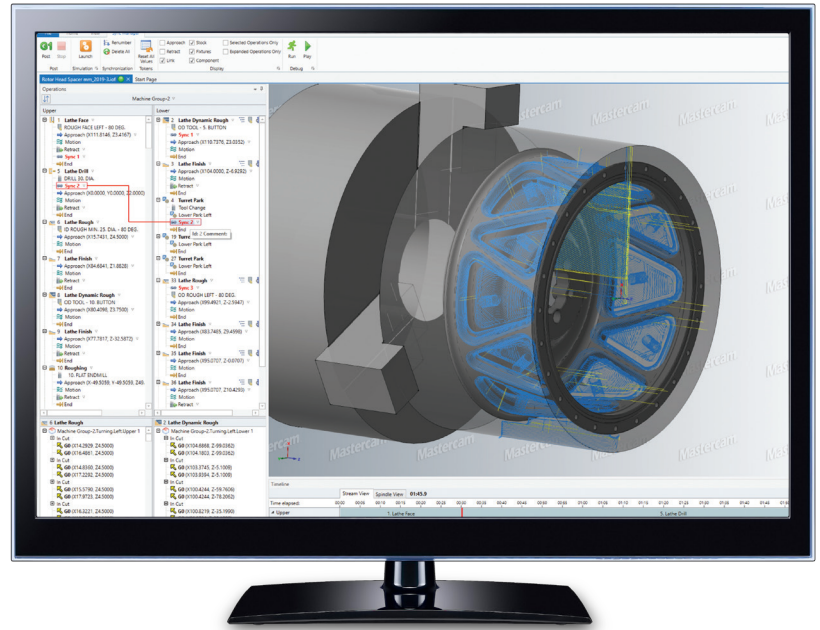

*Fast, flexible setup, synchronization, and simulation combine to help you get the most out of your mill-turn machines.*

## Get more out of your machines with Machine Simulation.

Machine Simulation provides visual verification and assurance that the interaction and syncing between operations performs exactly as you planned. Validate against potential collisions and track cycle time estimates to achieve maximum efficiency.

## Avoid mistakes. Save time and money.

Machine components, custom workholding, multiple steady rests, tailstock, tools, and parts are simulated from the safety of your desktop, ensuring a safe and secure machining experience. You can identify potential collisions, see your cutting motion, and explore ways to optimize your processes with simulation. View all streams and statistics of the entire machining process, with the capability to jump to any point in the process with the click of a button.

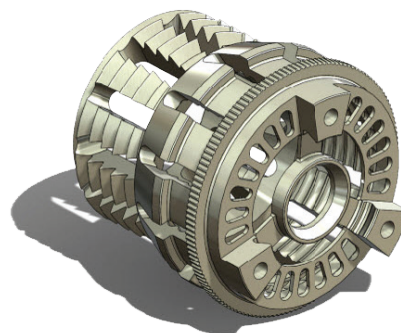
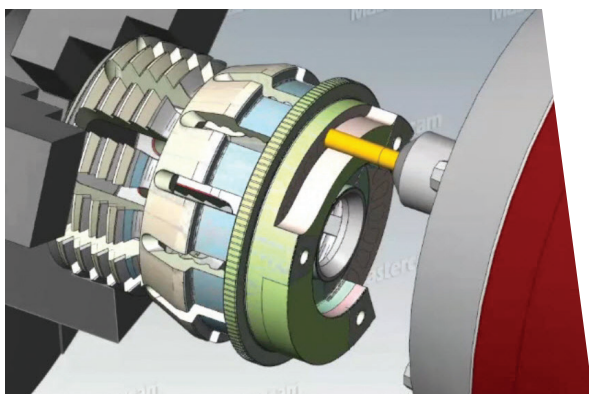

*Get the most from your machine with multistation and half-index tool support.*

# WIRE

Mastercam Wire delivers powerful, comprehensive wirepaths in a streamlined, easy-to-use interface.

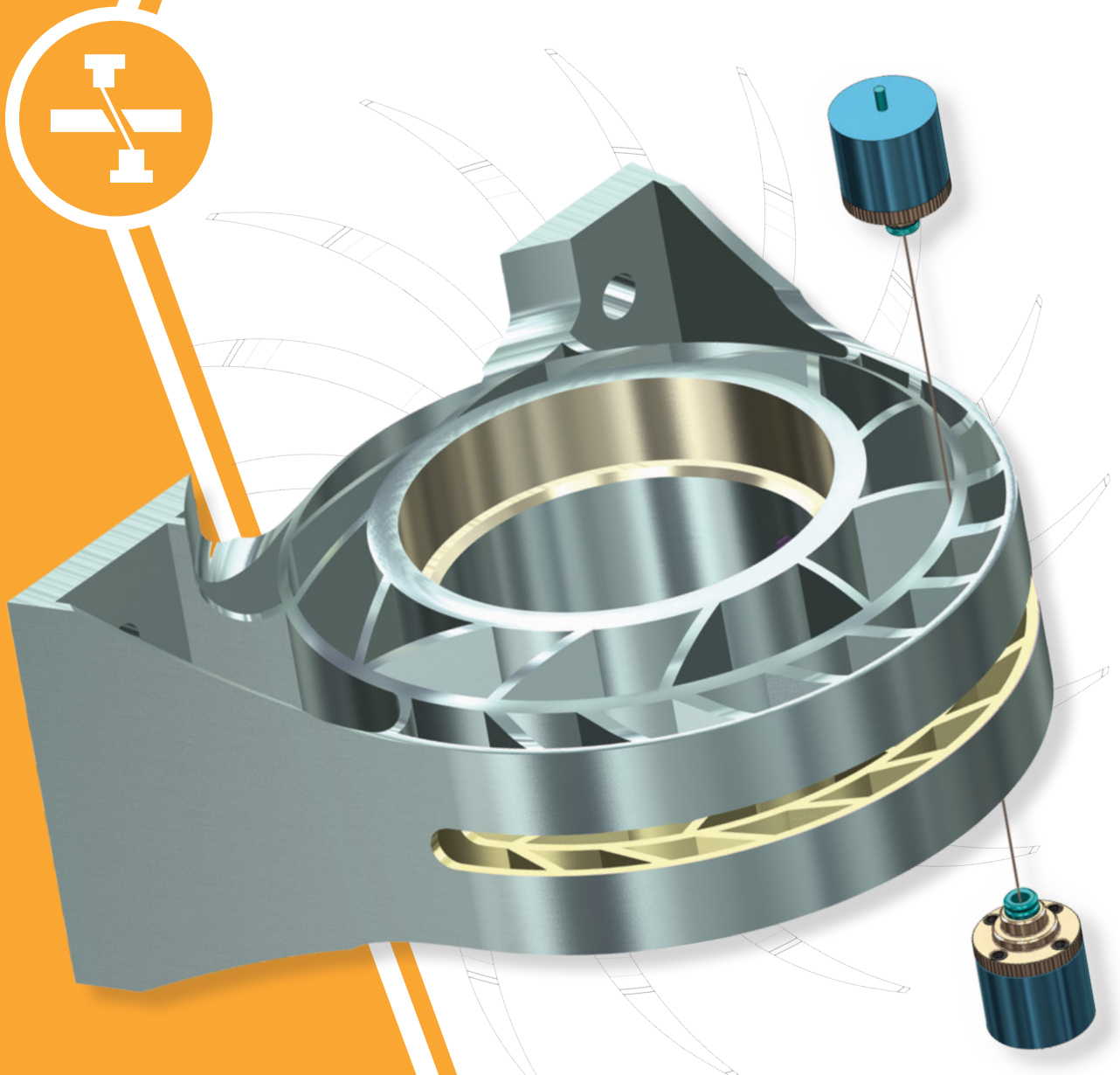



# MASTERCAM CONTROL FOR WIRE EDM

## Designed for efficiency.

Mastercam Wire lets you move a single part file between machines, saving time and avoiding mistakes. User-customizable wire libraries store power settings and other registers for rough and skim passes.

Other features include:

- Efficient tab creation and management.
- Control settings for corner types and taper angles at any point in the contour.
- Straight or tapered cut from either direction.

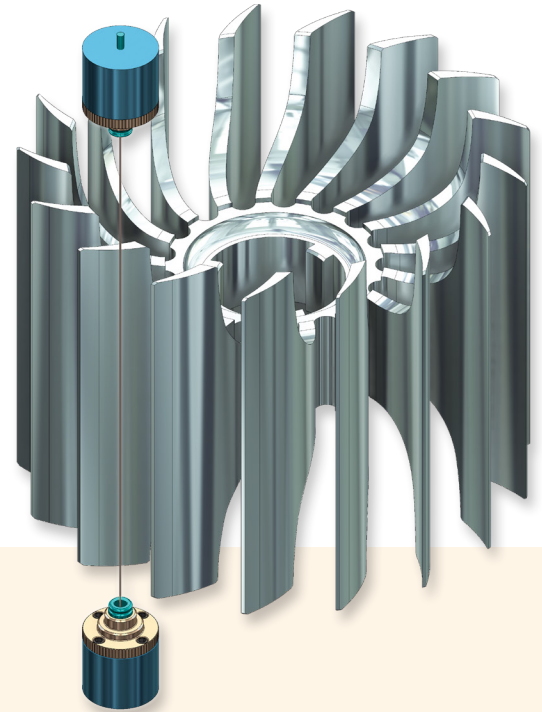

## Choosing the best software for your success includes many factors to consider.

A global community of Mastercam users, experts, educators, and enthusiasts helps you get the most from your investment. Mastercam Resellers bring years of experience, helping to ensure that you are getting the most practical and comprehensive support in the industry.

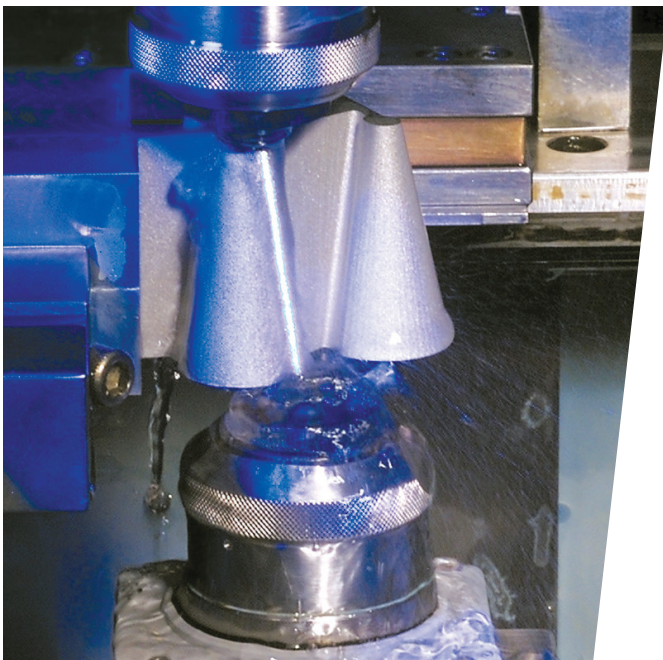

## Expand your shop's capabilities.

For basic 2-axis contouring and complex 4-axis motion, you can be ready for any job. Mastercam delivers:

- **Contouring** made easy in 2- or 4-axis.
- **Automatic** lead-in and lead-out strategies.
- **Automatic or manual** 4-axis syncing.
- **Automatic** skim and reverse cuts.

Open virtually any CAD file or use Mastercam's built-in 3D modeling tools.

*From 2- and 4-axis cutting to easy syncing and complete tab control, Mastercam Wire delivers tools for fast, efficient wire programming.*

# ROUTER

Mastercam Router delivers complex routing functionality from an easy-to-use interface.

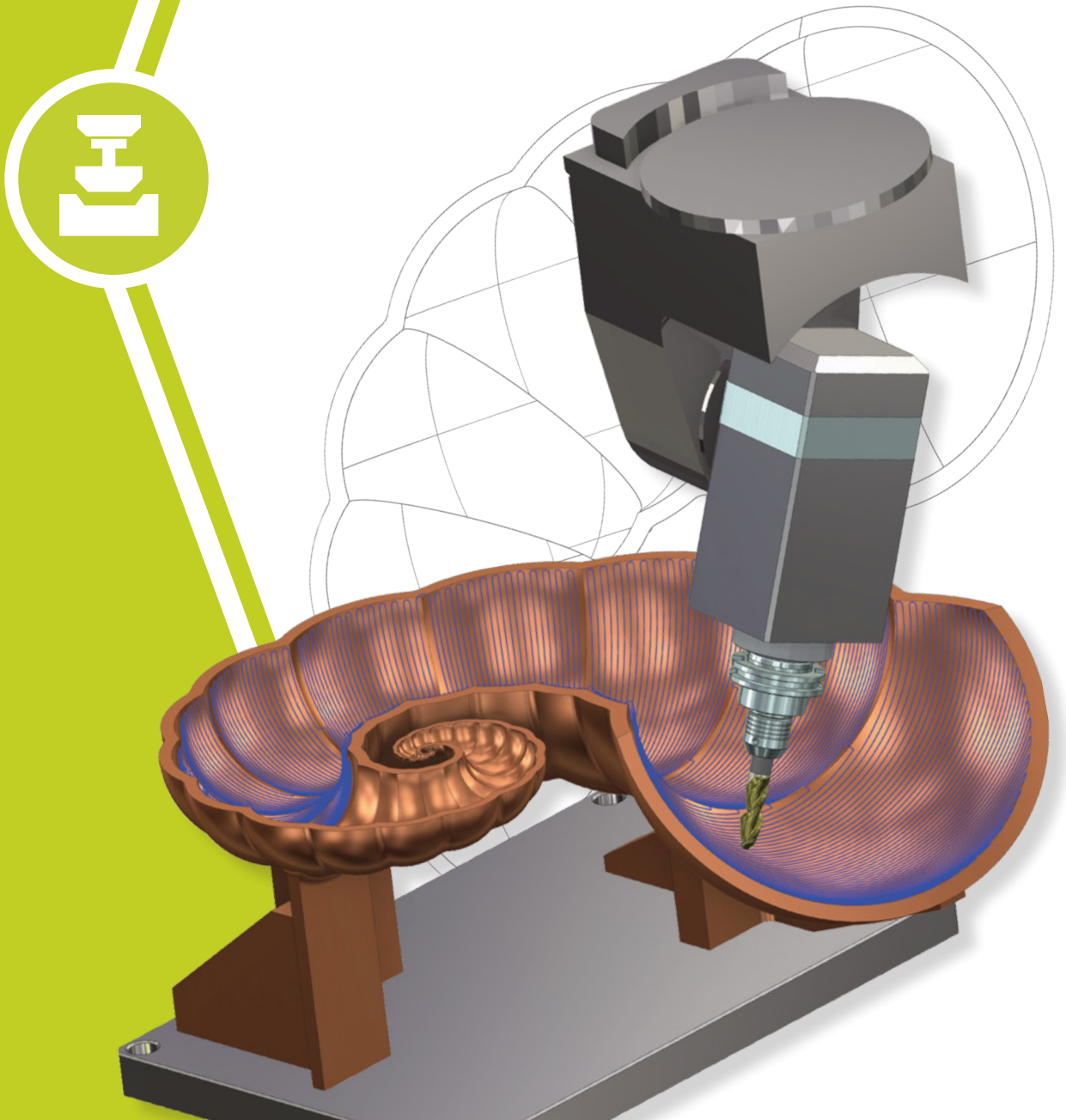

# FLEXIBILITY AND CONTROL

**Mastercam Router offers solutions for all your 2D, 3D, or multiaxis challenges — from wood to composites.**

Once you program a part, no matter how complex, you can modify any element of the job and get updated toolpaths without slowing down. You can also build a library of your favorite machining strategies and apply them to new models.

Mastercam's powerful Dynamic Motion technology not only helps extend tool life and reduce machine wear, but helps eliminate tool dwell damage as well. **Automatic Toolpathing (ATP)** brings in parts from today's top design packages to help speed flat panel work.

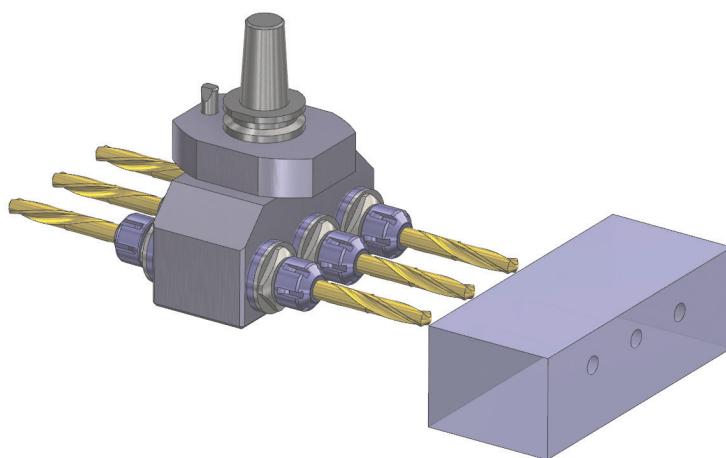

*Mastercam Router streamlines multiple tool programming including block drills and aggregate heads.*



*Part and toolpath nesting increase project yields and profitability.*

## A comprehensive package of powerful tools.

2D machining can range from simple to very complex. Mastercam Router delivers powerful 2D tools from nesting, contouring, pocketing, and drilling to automated, feature-based, solid model programming.

For 3D machining, Mastercam Router gives you streamlined, efficient 3D roughing and finishing, including automated leftover stock cleanup.

Mastercam's multiaxis capabilities give you complete control over the three crucial elements of multiaxis machining: cut pattern, tool axis control, and collision avoidance.

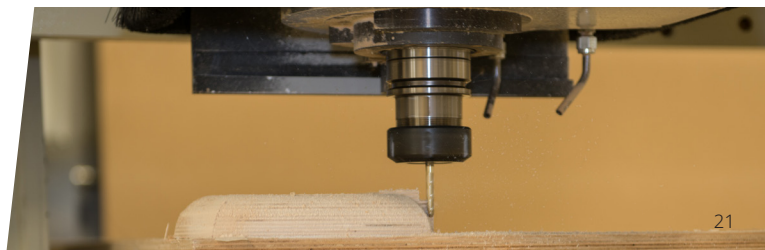
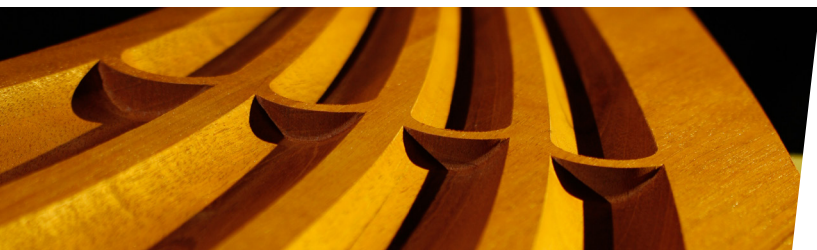



# DESIGN

Focused CAD means machine-ready parts faster.

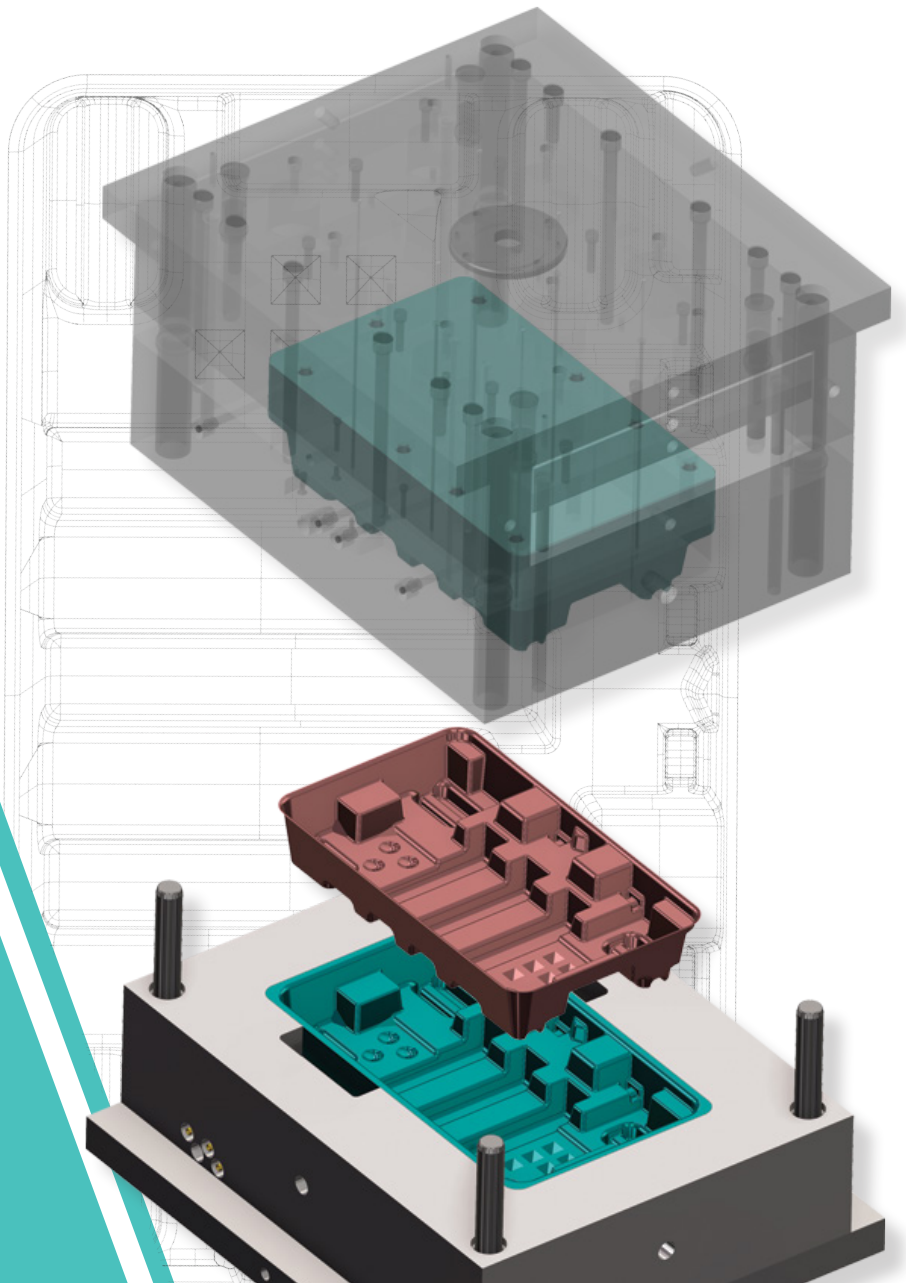

# MODELING AND PREP TOOLS

## Get your parts on and off the machine quickly.

Whether you bring in a file from an outside CAD package or design one yourself, Mastercam's powerful, easy-to-use CAD engine is included in each main Mastercam product and is also available separately.

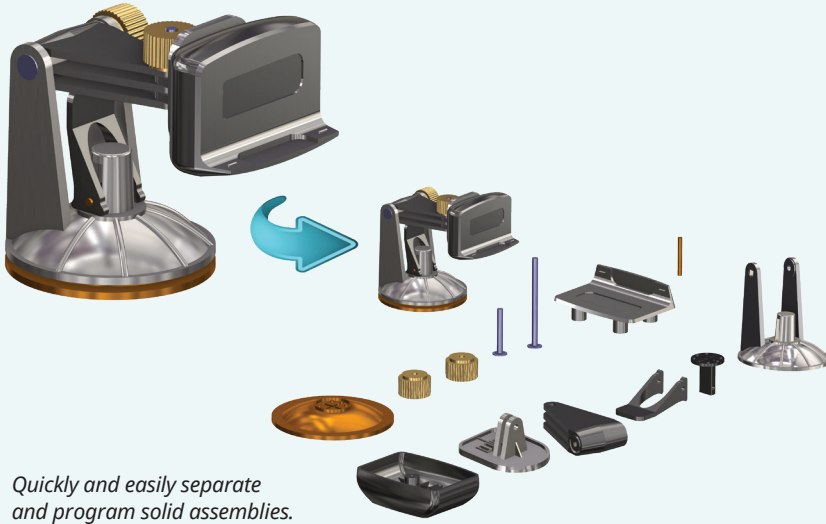

*Quickly and easily separate and program solid assemblies.*

## Work with your existing CAD files.

Mastercam helps to preserve design intent with Model Based Definition (MBD) support and acceptance of varied file formats. These include IGES, Parasolid®, SAT (ACIS solids), AutoCAD® (DXF, DWG, and Inventor™ files), SOLIDWORKS® (including history tree), Solid Edge®, SpaceClaim, STEP, STL, and more. Add-On translators are available for Siemens NX, CATIA™, Pro/E (PTC Creo), and more.

## Whether you are prepping customer files...

Getting a part file from an outside source can pose unique challenges. You might need to repair a surface, cap or hide a feature, or create an electrode. You may need to streamline, fix, or modify a complex mesh, or just make sure your fixtures are represented on the part. Mastercam includes a powerful set of model prep tools to make sure the process goes smoothly. Focused mesh, surface, and solid model creation and editing tools let you bring a part from the designer's desk to your machining process, fast.

## ...or designing your parts from scratch.

Having powerful CAD at your fingertips makes your CAM system that much more effective. Mastercam includes a robust set of modeling tools, from complete wireframe to surface and solid modeling. A true hybrid modeling system, Mastercam lets you create, combine, and machine whichever CAD geometry suits your needs.

Top	Depth	Bottom	Taper
69.85	0.381	69.85	0.0
49.8348	3.3528	48.03804	30.0
48.03804	0.20652	47.625	90.0
47.625	15.49068	47.625	0.0
45.5676	4.0894	45.5676	0.0
45.5676	5.58954	25.4	122.0
25.4	21.69006	25.4	0.0
25.4	7.03972	0.0	122.0

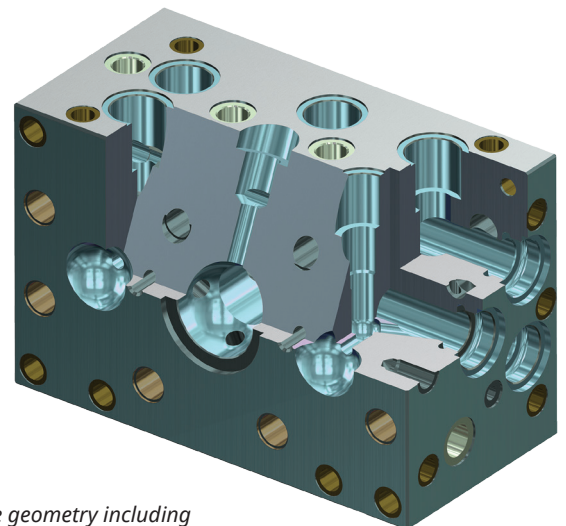

*Automatically identify complex hole geometry including intersecting and non-conventional holes.*



# EDUCATIONAL SUITE

Mastercam empowers students with the CAD/CAM skills they need for successful careers in manufacturing.

## FROM THE CLASSROOM TO THE PRODUCTION FLOOR

### Shape the future. Teach with Mastercam.

The Mastercam Educational Suite gives teachers the power to put the world's #1 CAM software at students' fingertips, because your students deserve the best.

Our Educational Suite\* comes complete with the following:



MILL



LATHE



WIRE



ROUTER



DESIGN



ART



PRODRILL



DATA  
TRANSLATORS

### Every classroom and program is different.

Mastercam gives you the power to customize solutions to the unique requirements of your curriculum.

Mastercam Add-Ons available for specialty manufacturing include:



MULTIAXIS



MILL-TURN



PORT EXPERT



BLADE  
EXPERT



PRODUCTIVITY+

*\*Solutions in the Mastercam Educational Suite provide the same interface and capability to drive CNC equipment as industrial versions, but files are saved in a format that is not compatible with industrial versions of Mastercam.*



# PREPARE YOUR STUDENTS TO SHAPE THE FUTURE OF MANUFACTURING

- **One-stop solution** offering CAD, milling, turning, wire EDM, and more.
- **Easy to teach** and easy to learn with a simplified user interface option — great for new users.
- Trusted platform with **30+ years** of direct service to educators.
- **Technological leadership** gives students access to tools used in professional shops.
- **Free resources** for teachers and students include Mastercam Home Learning Edition.
- **Open platform** lets you design in Mastercam or use CAD files from other sources.

## The World Leader in NC Programming



**Installed Seats**  
(in thousands)

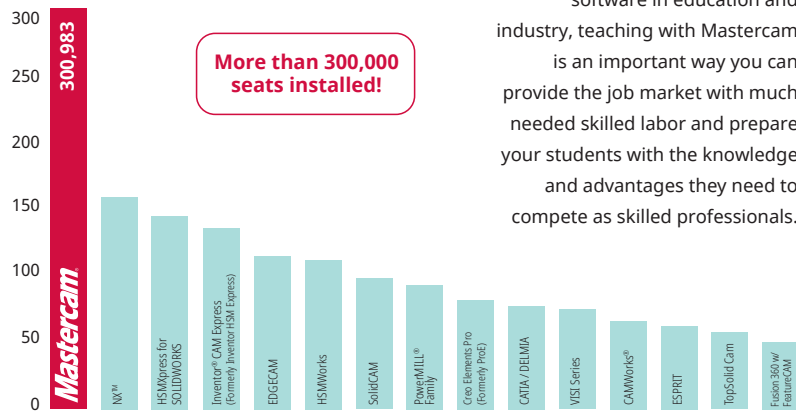

**More than 300,000 seats installed!**

As the most widely used CAM software in education and industry, teaching with Mastercam is an important way you can provide the job market with much needed skilled labor and prepare your students with the knowledge and advantages they need to compete as skilled professionals.

## User Support

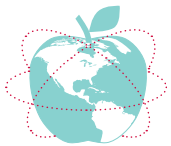

Mastercam Resellers form a much needed conduit between education and industry. Teachers and students gain direct access to our industrial channel's deep knowledge of CAD/CAM and manufacturing options. And when students are ready for the job market, they benefit as members of the world's largest industrial CAM network.

## Mastercam Educators Alliance



The Mastercam Educators Alliance (MEA) is a growing community of educators who teach and use Mastercam. It provides a platform to interact with other instructors and gain access to subject matter experts and content that is tailored to the needs of MEA members.

## Student Outreach

Mastercam is dedicated to future generations of makers. We are strong supporters of a number of motivational competitions for students.



# CONNECTED CAM FOR



## PARTNERSHIPS

### Our collaborations drive innovation.

Our partnerships with industry leaders help us develop Mastercam to push the limits of machining speed, precision, and efficiency. We work with machine tool developers, tool manufacturers, and Industry 4.0 experts to develop advanced manufacturing strategies, so our users can safely and reliably benefit from established and emerging technologies.

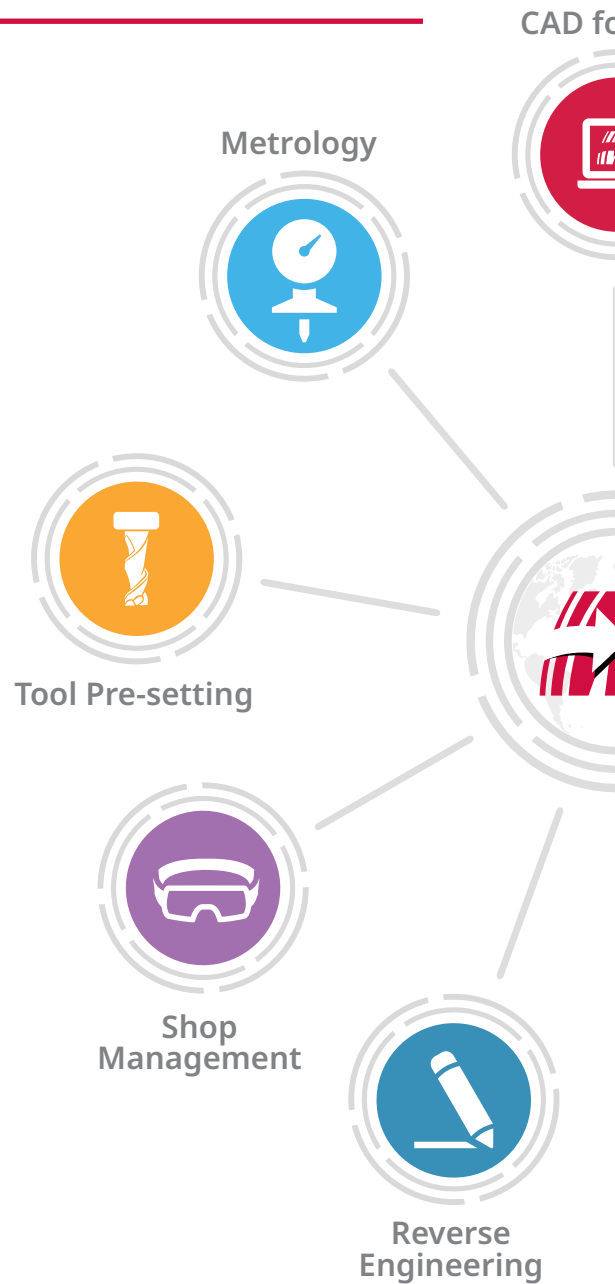

Our success is a direct result of staying connected to our customer base, our partner network, and manufacturing-at-large. We collaborate across industry and education to adapt to changing needs and ensure you have ample access to the technology and skilled labor force required to improve manufacturing outcomes.

# A CONNECTED WORLD

or CAM



## MANUFACTURING LAB

**We break tools so you don't have to.**

Our on-site machine shop tests new techniques and equipment in a practical shop setting. Our team of applications engineers provides research and development support through software testing, component manufacturing, troubleshooting, and more, to continuously refine our product to meet the evolving needs of manufacturing firms.

Like you, we are using data to make faster, better decisions, reduce bottlenecks, and solve problems.

Mastercam leverages an open platform and premier partnerships to give our users access to everything from paperless workflow and reverse engineering to digital tool management and robotics — and incomparable customer support.



# TOOLS TO KEEP YOURSELF COMPETITIVE



## Mastercam University®

Online, video-based training developed by Mastercam and trusted partners. Sharpen your skills on your own schedule, use it to bolster your resume, and access the materials you need for Mastercam Certification. Mastercam University is easy to use, gives you real-world training applications, and covers all levels of Mastercam skills from basic to advanced.

[University.Mastercam.com](http://University.Mastercam.com)



## Mastercam Certification

If you are looking to set yourself apart as a skilled Mastercam programmer in the increasingly competitive job market, Mastercam Certification is the answer. Your path to Mastercam Certification begins at Mastercam University. With certified Mastercam credentials, you can advance your programming skills and earn the competitive advantage you seek.





## Mastercam Training and Support

CAD/CAM is a support-intensive business. We understand that our users require comprehensive training options to get started with Mastercam and then to stay current with the latest advancements.

To get the best training, you need flexible options, and the strength of the Mastercam community means our users have access to a global network of excellent opportunities for training.

### Corporate Training

- Mastercam University offers online training courses with video-based instruction in a variety of CAD/CAM disciplines.
- Live, virtual training sessions offered throughout the year from our corporate offices.
- PDF tutorials and the Mastercam Knowledge Base are accessible with your [Mastercam.com](https://www.mastercam.com) account.

### Mastercam Reseller Training

- Your local Reseller is the best place to find out about training opportunities using the world's most widely used CAM software. Mastercam Resellers can help you access on site, classroom, and virtual trainings for everything from standard skills tutorials to customized CAD/CAM workshops for the specific needs of your manufacturing enterprise.

### Third-Party Training

- As the most widely used CAM software, Mastercam users also enjoy access to a variety of training options available from official, third-party training partners.





# THE CHOICE IS YOURS

When you choose Mastercam, you get more than a license to run CAD/CAM software. You secure flexible options to empower your business and manufacturing operations — with the added value of shop-tested technology, responsive support, and a voice to guide future CAD/CAM developments.

## FOR A MANUFACTURING SOLUTION THAT WORKS FOR YOU, CHOOSE MASTERCAM.



Trusted software and the world's largest CAM network give you the power to advance your manufacturing at a pace that works for you.



Perpetual licensing is available to operate Mastercam at a lower price over time, to complement long-term planning and budgeting capabilities.



Subscription licensing gives you lower up-front costs and renewable, term-based access to Mastercam with steady, predictable payments.



Mastercam Maintenance maximizes your productivity with priority access to the latest software, customer support, and so much more.

**For more information, contact a local Mastercam expert at  
[Mastercam.com/Resellers](https://www.mastercam.com/Resellers).**

CNC Software, LLC  
671 Old Post Road  
Tolland, CT 06084 USA



[www.mastercam.com](https://www.mastercam.com)

# **Mastercam**<sup>®</sup>

Mastercam<sup>®</sup> is a registered trademark of CNC Software, LLC. All other trademarks are property of their respective owners.  
©1983-2022. All rights reserved.